

 4  3  2



Springfield Road, *Windsor*

OSBORNE HEATH

A four bedroom, two bathroom home extended to the rear and into the loft, with a 23ft kitchen and dining room plus a covered outdoor terrace.

On the ground floor there is a living room with a bay window, office also used as an occasional bedroom, a 23ft kitchen and dining room with bi-fold doors out to the garden, and a downstairs WC.

The first floor has three bedrooms and a shower room, with a principal bedroom and en suite bathroom in the top floor loft conversion.

Outside, there is an enclosed front garden with a pathway to the front door. At the rear is a delightful covered decked terrace with steps down to a mature rear garden, and a timber garden shed.

The property is situated within walking distance of the town centre, close to local shops and the Alma public house. Windsor has a wide range of shops and restaurants as well as the Castle, Great Park, Racecourse and Legoland. Nearby train stations include Windsor & Eton Central and Windsor & Eton Riverside where trains run to London Paddington (via Slough - Elizabeth Line) and London Waterloo. Windsor is also convenient for the M4, M25 and Heathrow Airport. The area also has a good selection of state, private and international schools.

EPC rating C. Council Tax band E.





APPROXIMATE FLOOR AREA
House - 120.10 sq m - 1293 sq ft
(Gross Internal Area)



NOT TO SCALE
This plan is for illustration purposes only

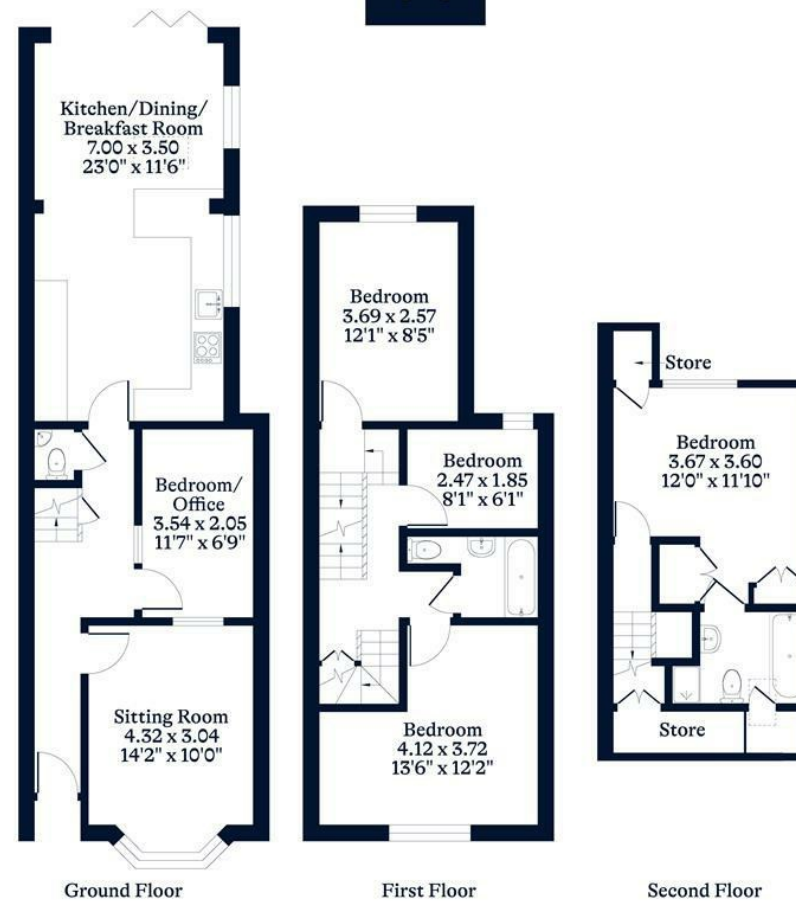

This plan is for layout guidance only. Not drawn to scale unless stated. Windows and door openings are approximate. Whilst every care is taken in the preparation of this plan, please check all dimensions, shapes and compass bearings before making any decisions reliant upon them.

OSBORNEHEATH.CO.UK